

XHA™ Extra Hi-Amplitude Electric Vibrator

An economical solution for material-flow problems in bins & hoppers containing lumpy, sticky, or light fluffy materials. The high-amplitude, low-frequency (1800 rpm) generated is ideal for compacting and screening applications.

MARTIN® XHA 1800 rpm Electric vibrators are the perfect choice for compaction table drives and other amplitude-sensitive applications. We also fabricate custom compaction table assemblies.

MARTIN® XHA High Amplitude Electric Vibrators are designed and built to withstand the rigors of the industrial environment; so tough we guarantee them for 3 years. **Available in single-phase and 3-phase models from 200-20,000 force pounds. 900, 1200, 1800 and 3600 rpms. All of our electric vibrators are available in safety voltage.** **Note:** Vibrators sized for material 50-90 lbs. per cu./ft. with 5% or less moisture content. Contact factory for other material.



FEATURES

Quiet

Operates at 60 - 70 dBA, the same as a standard electric motor. Air driven piston vibrators operate as high as 120 dBA.

Sanitary Design

Epoxy coating and stainless steel end caps makes the new MARTIN® XHD Series perfect for sanitary applications.

Built to Last

Vacuum impregnated windings, o-ring seals, and machined surfaces provide an IP 66 rating to protect against the entry of dirt or water, virtually eliminating the possibility of failure.

Other Equipment & Services

Mounting brackets, timers, and controls. All single phase units contain overload, starting capacitor, switch box and cord standard. All units are available without these components at a reduced price.

Additional Specifications

- Operating Temperature: 3 Phase: -22° - 104° F, 1 Phase: 32° - 104° F.
- Adjustable Output: Weights can be positioned for precise control of force.
- Force (maximum): 2300 force-lbs.
- Warranty: 3-years when operated within recommendations.
- Included: 115 Volt Single Phase units include switchbox, overload protection, capacitor and cord.

XHA™ Extra Hi-Amplitude Electric Vibrator

XHA DIMENSIONS

XHA SERIES						
1800 RPM	A	B	C	D	E	F
A0.5T & C0.5T	8.23(209)	6.08(154.5)	6.46(164)	2.56(65)	5.51(140)	0.98(25)
A1.5T & C1.5T	9.49(241)	6.08(154.5)	6.46(164)	2.56(65)	5.51(140)	0.98(25)
A3.5T & C3.5T	11.61(295)	6.91(175.5)	6.46(164)	2.56(65)	5.51(140)	0.98(25)
A6.5T & C6.5T	13.39(340)	7.68(195)	8.54(217)	3.94(100)	7.09(180))	1.18(30)
A8.5T & C8.5T	14.49(380)	7.68(195)	8.54(217)	3.94(100)	7.09(180)	1.18(30)
C11.5T	14.88(378)	8.31(211)	8.46(215)	3.94(100)	7.09(180)	1.38(35)
	G	H	I	L	M	N
A0.5T & C0.5T	0.51(13)	3.78(96)	1.77(45)	3.94(100)	5.04(128)	4.61(117)
A1.5T & C1.5T	0.51(13)	3.78(96)	2.4(61)	3.94(100)	5.04(128)	4.61(117)
A3.5T & C3.5T	0.51(13)	4.13(105)	2.91(74)	4.88(124)	5.04(128)	5.55(141)
A6.5T & C6.5T	0.67(17)	4.53(115)	3.58(91)	5.63(143)	5.67(144)	6.30(160)
A8.5T & C8.5T	0.67(17)	4.53(115)	4.37(111)	5.63(143)	5.67(144)	6.30(160)
C11.5T	0.67(17)	3.68(93.5)	3.86(98)	6.61(168)	5.67(144)	7.17(182)
inches(mm)	"A" Series = 115 VAC 1ph			"C" Series = 220/440 VAC 3ph		

XHA

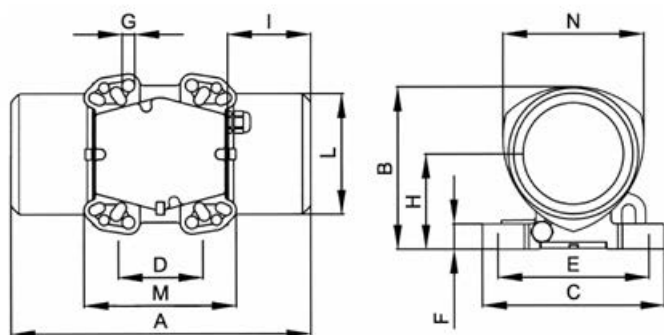

XHA

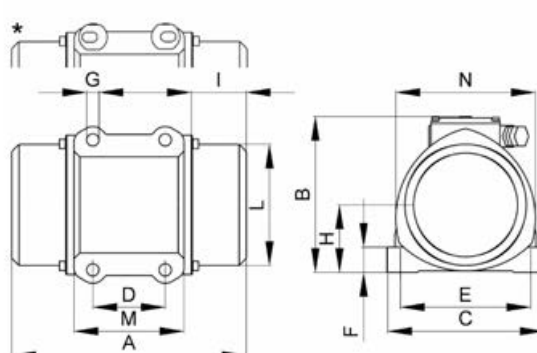

XHA™ Extra Hi-Amplitude Electric Vibrator

XHA 1 PH PERFORMANCE DATA

		UNBALANCE	CENTRIFUGAL FORCE	POWER INPUT	MAX AMP DRAW
MODEL	TYPE	IN/LBS (CMKG)	FORCE LBS (N)	(KW)	115
XHA-A0.5T	NEA 2530	2.08(2.4)	95.8(426)	0.095	1.0
XHA-A1.5T	NEA 2570	4.17(4.8)	160(711)	0.095	1.0
XHA-A3.5T	NEA 25210	10.24(11.8)	471(2097)	0.17	2.0
XHA-A6.5T	NEA 25420	19.7(22.7)	907(4033)	0.35	2.80
XHA-A8.5T	NEA 25540	28.3(32.6)	1302(5792)	0.35	2.80

XHA 3 PH PERFORMANCE DATA

		UNBALANCE	CENTRIFUGAL FORCE	POWER INPUT	MAX AMP DRAW
MODEL	TYPE	IN/LBS (CMKG)	FORCE LBS (N)	(KW)	230/460
XHA-C0.5T	NEG 2530	2.08(2.4)	95.8(426)	0.095	0.4/0.2
XHA-C1.5T	NEG 2570	3.47(4)	160(711)	0.095	0.4/0.2
XHA-C3.5T	NEG 25210	10.24(11.8)	471(2097)	0.17	0.8/0.4
XHA-C6.5T	NEG 25420	19.7(22.7)	907(4033)	0.35	1.2/0.6
XHA-C8.5T	NEG 25540	28.3(32.6)	1302(5792)	0.35	1.2/0.6
XHA-C11.5T	NEG 25700	36.37(41.9)	1674(7445)	0.665	1.96/0.98

PHOTOS



MARTIN® XHA Series
Extra Hi-Amplitude
Electric Vibrator