

Micro™ Series Electric Vibrators

MARTIN® MICRO™ Rotary Electric Vibrators have all the rugged design characteristics required of a continuous-duty vibrator, wrapped in a small package. They are ideal for small feeding, screening, calibrating, separating and compacting applications that are found in food, chemical and pharmaceutical facilities.

NEW! MICRO SERIES

Available in four compact sizes. Great for packaging & bottling systems!



FEATURES

No Lubrication Required

MARTIN® MICRO™ Electric Vibrators are built with permanently-lubricated bearings. No maintenance is required.

Quiet

Noise levels are than 60 dBA, well below regulatory limits.

Energy-Efficient

The operating costs of electric vibrators is a fraction of the cost of pneumatic vibrators.

Sanitary

Sanitary Design, Epoxy Coating & Stainless Steel end caps.

Additional Specifications

- Electrical Specifications: 115-V, 60-Hz - Standard, other voltages available, including safety voltage
- Included: M-16/NEA 504-3' cord set, M-60-6' cord with switch box, NEA 5020-2 Meter cord, inline capacitor.
- Operating Temperature: 32° - 110°F.
- Force (maximum): 60 force-lbs.
- Included: M-16/NEA 504-3' cord set, M-60-6' cord with switch box, NEA 5020-20' cord, inline capacitor.
- 1-Year Warranty
- Noise Levels: 60 dBA

PHOTOS

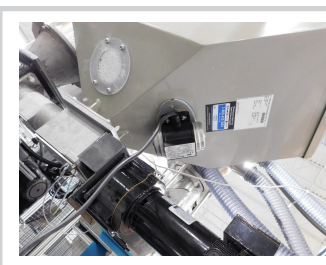

Micro™ Series Electric Vibrators

DIMENSIONS

	A	B	C	D	E	F	G	H	I	M	N	L
NED 5016	4.76(121)	3.03(77)	3.03(77)	-	2.20(56)	-	0.35(9)	1.52(38.5)	1.14(29)	2.48(63)	-	2.99(76)
NEA 504	4.37(111)	2.64(67)	3.54(90)	1.57(40)	2.95(75)	0.35(9)	0.22(5.5)	1.34(34)	0.94(24)	2.32(59)	2.56(65)	2.48(63)
NEA/NEG 5020	6.18(157)	2.95(75)	4.33(110)	2.36(60)	3.35(85)	0.35(9)	0.26(6.5)	1.50(38)	1.30(33)	3.27(83)	2.91(74)	2.83(72)
NEA/NEG 5050	6.65(169)	2.95(75)	4.33(110)	2.36(60)	3.35(85)	0.35(9)	0.26(6.5)	1.50(38)	1.54(39)	3.27(83)	2.91(74)	2.83(72)

NED

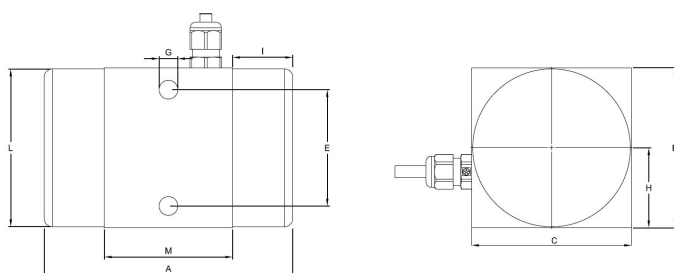

NEA/NEG

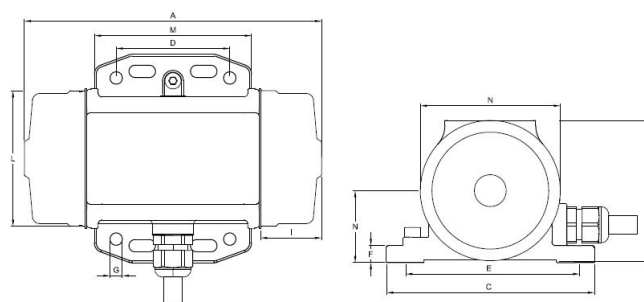

PERFORMANCE DATA

	UNBALANCE IN/LBS (CMKG)	CENTRIFUGAL FORCE LBS. (N)	POWER INPUT (KW)	MAX AMP DRAW	
				230/460	
NEG 5020	0.35(0.4)	63.85(284)	0.035	0.26/0.15	
NEG 5050	0.87(1)	159.8(711)	0.045	0.28/0.16	

PERFORMANCE DATA

	UNBALANCE IN/LBS (CMKG)	CENTRIFUGAL FORCE LBS. (N)	POWER INPUT (KW)	MAX AMP DRAW	
				12/24	115/220
NED 5016	0.06(0.07)	47.88(213)	0.02	1.4/0.6	-
NEA 504	0.09(0.1)	15.96(71)	0.024	-	0.3/.013
NEA 5020	0.35(0.4)	63.85(284)	0.035	-	0.42/0.17
NEA 5050	0.87(1)	159.8(711)	0.045	-	0.46/0.2