

MARTIN® Ball Vibrators

Vibrolator® Pneumatic Ball Vibrators provide high-frequency vibration at an economical price. The only moving part is a high-grade chrome steel ball. Lubrication, while not required, extends the life of the units.



The best uses for this series are small hoppers, parts feeders, chutes and match plates. Air consumption for these units is moderate. If the application requires more than three hours per day of operation or requires lubrication-free operation, the **MARTIN® NCT™ Turbine Vibrators** may be a better choice.

FEATURES

Cost Effective Replacement

Designed to interchange with most brands of ball vibrators, providing a very cost-effective replacement. This type of industrial vibrator has been in use for over 50 years.

Versatile

Originally developed for use in foundries, these versatile units are now used to solve material-handling problems in many industries.

DIMENSIONS

MODEL	A	B	C	D	E	F	G	H	J	K	L	M
UCV-6	3 3/4	2 1/16	1 3/16	1 1/8	15/16	3	1/4	1/4	5/8	1/8		
UCV-13	5	2 19/32	1 5/16	1 13/32	1 7/16	4	5/16	3/8	3/4	1/8		
UCV-19	5	3 3/8	1 11/16	1 7/8	1 25/32	4	3/8	3/8	15/16	1/4		
UCV-25	6 1/2	3 7/8	2	2 1/8	2 11/64	5	7/16	1/2	1 1/4	1/4		
UCV-32	6 1/2	4 9/16	2 5/16	2 3/8	2 37/64	5	1/2	1/2	1 9/16	3/8		
UCV-38	7 3/4	5 3/16	2 5/8	2 7/8	2 29/32	6	9/16	5/8	1 7/8	3/8		
UCV-44	8 3/4	5 11/16	2 7/8	3 1/16	3 9/32	7	5/8	5/8	2 3/16	1/2		
BD-10	3 1/8	1 7/8	1 9/32	1 1/4	19/32	1 3/8	1/4	5/16	7/8	1/8		
BD-13	3 3/4	2 3/16	1 3/8	1 5/8	5/8	1 9/16	5/16	3/8	1 1/8	1/4		
BD-16	4 1/8	2 9/16	1 9/16	1 11/16	13/16	1 13/16	3/8	3/8	1 1/4	1/4		
BD-19	4 7/16	2 3/4	1 23/32	1 7/8	13/16	1 15/16	3/8	3/8	1 5/16	1/4		
BD-25	5 7/32	3 1/4	2	2 5/32	1 5/64	2 5/16	1/2	1/2	1 5/8	1/4		
CV-10	3 7/8	2	1 1/4	1 1/4	19/32	3	1/4	5/16	3/4	1/8	1 21/32	1 1/16
CV-19	5 1/8	3 1/8	1 23/32	1 3/4	13/16	4	3/8	3/8	1 1/4	1/4	2 7/16	1 3/4
CV-25	5 1/4	4 1/4	2 1/4	2 1/4	1 1/8	4	1/2	1/2	1 3/4	1/4	3 5/8	2 1/2
CV-35	5 1/4	4 1/4	2 1/4	2 1/4	1 1/8	4	1/2	1/2	1 3/4	1/4	3 5/8	2 1/2
DV-41	6 1/2	4 3/4	2 13/16	2 5/8	1 1/2	5 1/2	1/2	3/8	2 1/8	3/8	3 15/16	1 1/4
DV-51	6 1/2	5 9/32	3 9/32	3 1/8	1 1/2	5 1/2	1/2	3/8	2 1/8	3/8	4 3/16	1 3/4

inches (mm)

MARTIN® Ball Vibrators

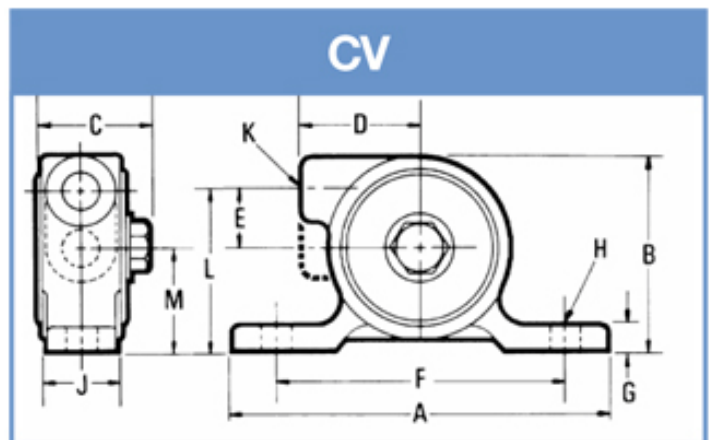
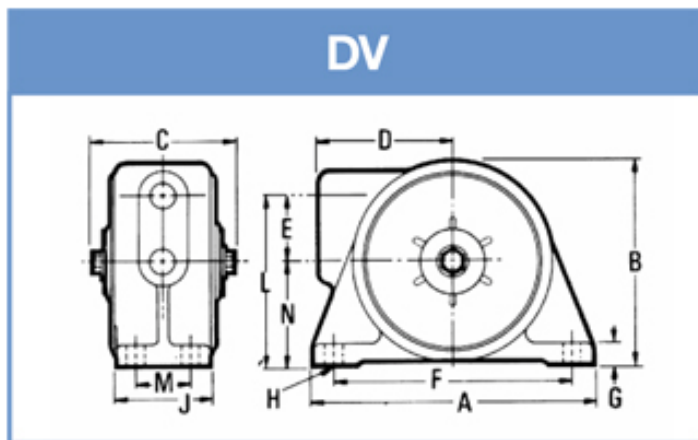
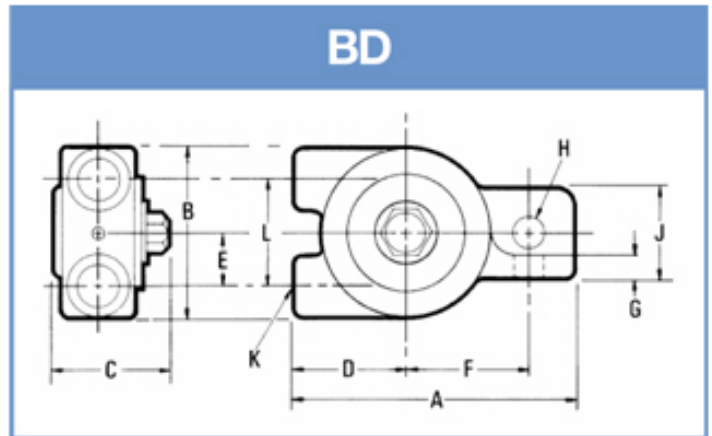
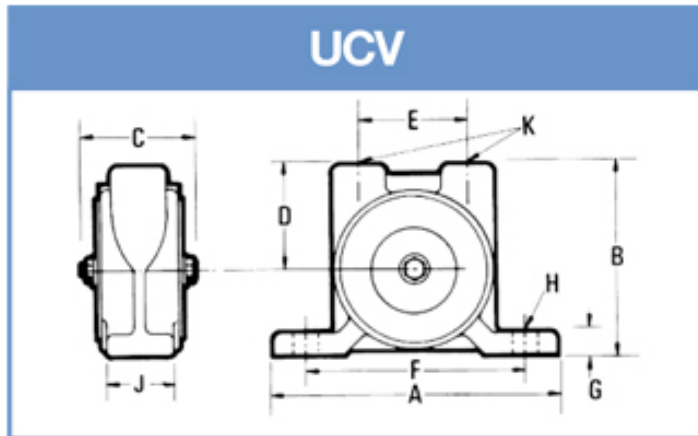

MARTIN® BALL VIBRATORS DIRECTLY INTERCHANGE WITH ALL THESE POPULAR MODELS.

BD-10	E-10	BB-100	BS-10	HB-10	ABL-10
BD-13	E-13	BB-130	N/A	N/A	ABL-13
BD-16	E-16	BB-160	BS-16	N/A	N/A
BD-19	E-19	BB-190	BS-19	HB-19	ABL-19
BD-25	E-25	N/A	BS-25	N/A	N/A
UCV-6	U-6	BV-60	N/A	N/A	N/A
UCV-13	U-13	BV-130	YS-13	HU-13	N/A
UCV-19	U-19	BV-190	US-19	HU-19	N/A
UCV-25	U-25	BV-250	US-25	HU-25	N/A
UCV-32	U-32	BV-320	N/A	N/A	N/A
UCV-38	U-38	BV-380	US-38	N/A	N/A
UCV-44	U-44	N/A	US-44	N/A	N/A
CV-10	VBF-10	V-100	N/A	N/A	ABF-10
CV-19	VBF-19	V-190	CS-19	HC-19	ABF-19
CV-25	VBF-25	V-250	CS-25	HC-25	ABF-25
CV-35	VBF-35	V-320	CS-35	HC-35	ABF-35
DV-41	F-41	N/A	DS-41	HC-41	ABF-41
DV-51	F-51	N/A	DS-51	HC-51	ABF-51

MARTIN® Ball Vibrators

PERFORMANCE

MODEL	FREQUENCY			FORCE LBS.			AIR CONSUMPTION (CFM)		
	20 PSI	40 PSI	60 PSI	20 PSI	40 PSI	60 PSI	20 PSI	40 PSI	60 PSI
UCV-6	17,000	22,000	25,000	8	14	18	2	3.5	4.5
UCV-13	12,000	15,000	19,000	33	51	82	2.5	5	7.5
UCV-19	10,500	14,000	16,000	115	205	270	4	7	11
UCV-25	7,500	9,700	11,000	175	275	380	6	10	13
UCV-32	5,100	6,500	7,500	185	285	390	6	11	17
UCV-38	4,200	5,500	6,200	240	410	560	7	14	20
UCV-44	3,900	5,100	6,000	300	530	710	9	15	21
inches (mm)									

MODEL	FREQUENCY			FORCE LBS.			AIR CONSUMPTION (CFM)		
	20 PSI	40 PSI	60 PSI	20 PSI	40 PSI	60 PSI	20 PSI	40 PSI	60 PSI
BD-10*	17,000	21,000	25,000	25	38	54	2	4	6
BD-13*	12,000	15,000	19,000	33	51	82	2.5	5	7.5
BD-16*	11,000	13,000	15,500	69	96	137	3	6	8
BD-19*	10,500	14,000	16,000	115	205	270	4	7	11
BD-25	7,500	9,700	11,000	175	275	380	6	10	13
inches (mm)									

MODEL	FREQUENCY			FORCE LBS.			AIR CONSUMPTION (CFM)		
	20 PSI	40 PSI	60 PSI	20 PSI	40 PSI	60 PSI	20 PSI	40 PSI	60 PSI
CV-10**	17,000	21,000	25,000	25	38	54	2	4	6
CV-19*	10,500	14,000	16,000	115	205	270	4	7	11
CV-25*	7,500	9,700	11,000	175	275	380	6	10	13
CV-35*	6,800	8,800	10,000	315	530	675	6	12	17
DV-41	3,200	4,300	4,900	255	460	600	9	16	24
DV-51	3,100	4,200	4,900	300	540	750	12	19	28
inches (mm)									